

The PROFIBUS Interface terminator is an active bus terminator. Its essential benefit is the fact that bus devices can be switched off, removed or replaced without impairing data transfer. This especially applies to bus devices on both ends of the bus line through which terminal resistances previously had to be switched and supplied.

**Explosion protection**

Marking ATEX	II 2G Ex d e IIC Gb I M2 Ex d e I Mb
Certification	PTB 97 ATEX 1068 U
Marking IECEx	Ex d e IIC Gb Ex d e I Mb
Certification	IECEx PTB 11.0083U
Marking CSA	Class I, Zone 1, IIC A/Ex d e [ia] IIC Gb
Certification	CSA 2011-2484303U
Other approvals and certificates, see <a href="http://www.bartec.de">www.bartec.de</a>	

**Technical data**

Construction	Flameproof, clip-on enclosure for TH 35 rail		
Enclosure material	High-quality thermoplastics		
Protection class	Module	IP 66	EN/IEC 60529
	Terminals	IP 20	EN/IEC 60529
Terminals	2.5 mm <sup>2</sup> , fine stranded		
Mounting rail	TH 35 x 7.5 (15) EN 60715		
Device designation	Front plate for labelling		
Storage temperature	-40 °C to +70 °C		
Ambient temperature	-25 °C to +60 °C at T4		
Weight	0.250 kg		

**Dimensions/mounting position**

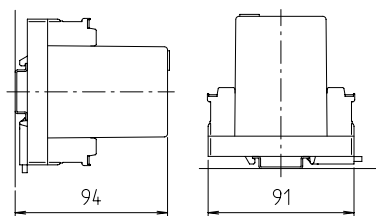

Module width: 30 mm

**Electrical data**

Supply voltage	DC 20 V to 30 V
Power consumption	$P_{tot.} = 0.3 \text{ W}$

**Ordering information**

PROFIBUS Interface terminator **07-7311-93WP/0000**

Technical data subject to change without notice.

**Wiring diagram/terminal assignment**

